

HQF CONNECTOR

Hinge type Board-to-board Connectors

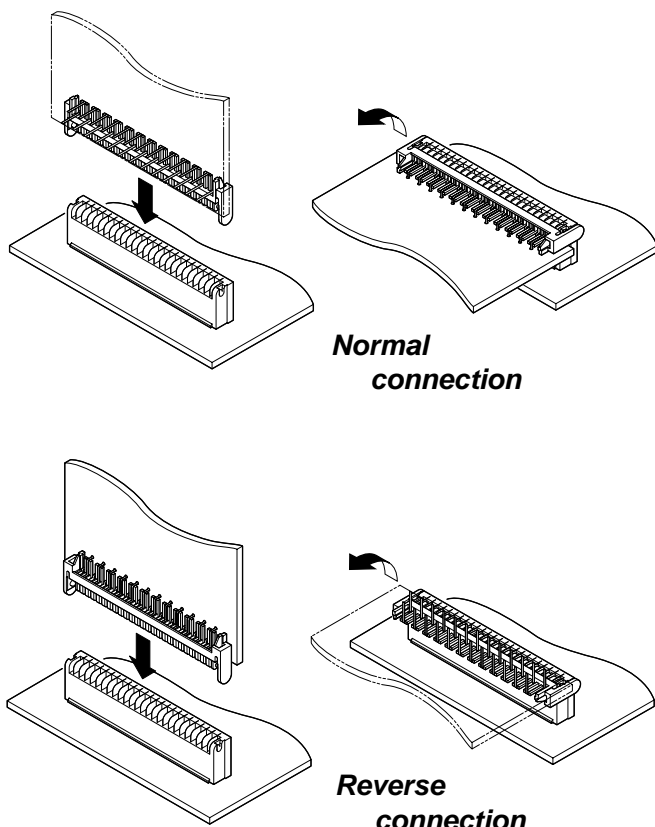

Hinge type board to board connectors which allow mated PCB's to move 90° in respect to one another while electricity is turned on. The hinge compensates for slight misalignments between circuit boards to assure a secure connection even if the boards are laterally out of line.



Features

• **Hinged connection**

With hinge construction, the HQF connector features flexibility. Thus this board to board connector allows mated PCB's to move 90° in respect to one another while electricity is turned on. Circuit checks can be made in any rotational position.

• **Flexible connection absorbs slight misalignments between boards**

Securely connected even if the adjoining boards are laterally out of line.

Specifications

- Current rating: 1.0A AC, DC
- Voltage rating: 100V AC, DC
- Temperature range: -25°C to +85°C
(including temperature rise in applying electrical current)
- Contact resistance: Initial value/40m Ω max.
After environmental testing/80m Ω max.
- Insulation resistance: 500M Ω min.
- Withstanding voltage: 500V AC/minute
- Applicable PC board thickness: 1.6mm
- * RoHS compliant products are published.
- * Refer to "General Instruction and Notice when using Terminals and Connectors" at the end of this catalog.
- * Contact JST for details.

Standards

Recognized E60389

Certified LR20812

HQF CONNECTOR

Plug

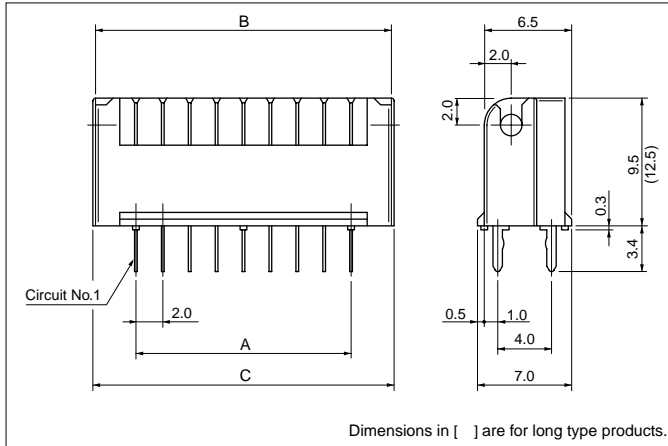

| Type | Circuits | Model No. | Dimensions (mm) | | | Q'ty / box |
|----------|----------|-------------------|-----------------|------|------|------------|
| | | | A | B | C | |
| Standard | 15 | 15P-HQF-E | 28.0 | 34.0 | 34.4 | 275 |
| | 15 | 15PL-HQF-A | 28.0 | 34.0 | 34.4 | 275 |
| Long | 25 | 25PL-HQF-A | 48.0 | 54.0 | 54.4 | 175 |
| | 35 | 35PL-HQF-A | 68.0 | 74.0 | 74.4 | 125 |

Material and Finish

Contact: Phosphor bronze, tin-plated (reflow treatment)
Housing: Glass-filled PA 66, UL94V-0

RoHS compliance

Receptacle

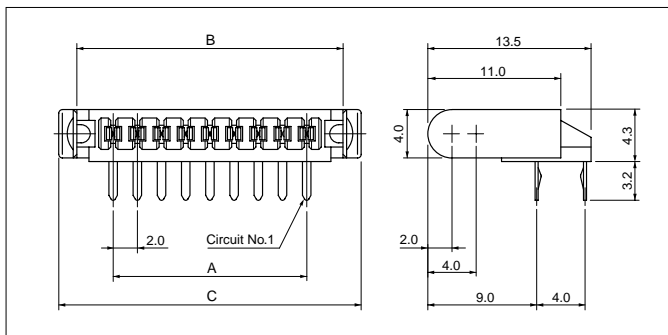

| Circuits | Model No. | Dimensions (mm) | | | Q'ty / box |
|----------|------------------|-----------------|------|------|------------|
| | | A | B | C | |
| 15 | 15R-HQF-A | 28.0 | 34.0 | 37.0 | 220 |
| 25 | 25R-HQF-A | 48.0 | 54.0 | 57.0 | 140 |
| 35 | 35R-HQF-A | 68.0 | 74.0 | 77.0 | 100 |

Material and Finish

Contact: Phosphor bronze, tin-plated (reflow treatment)
Housing: Glass-filled PA 66, UL94V-0

RoHS compliance

PC board layout (viewed from component side)

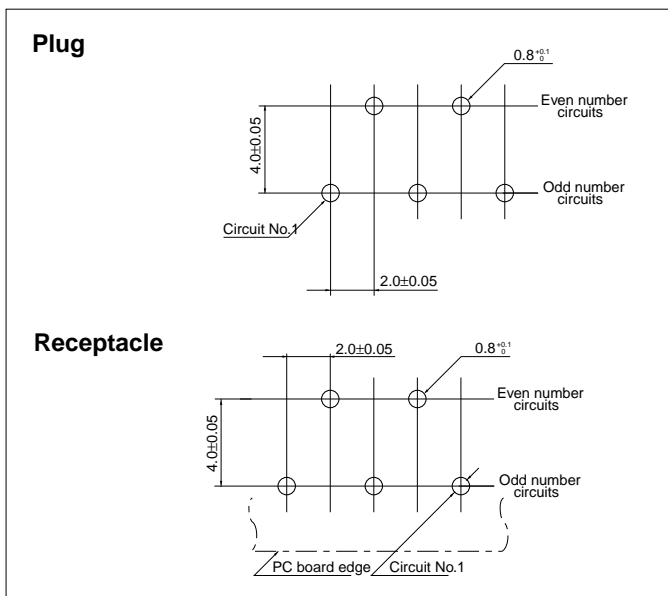

Assembly layout

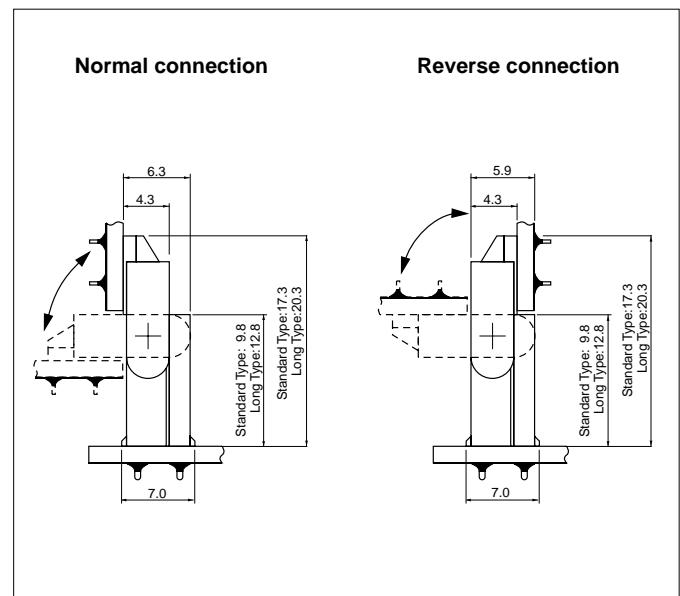

Note:

1. Tolerances are non-cumulative: $\pm 0.05\text{mm}$ for all centers.
 2. Hole dimensions differ according to the kind of PC board and piercing method. The dimensions above should serve as a guideline.
- Contact JST for details.