

SF12 Series IP67

**SF
12**



SF1210 / P — SF1210 / S

Cable connector
Mate with SF1211, SF1212, SF1213

Cable outer diameter
I: 4-6.5mm, II: 5-8mm
Number of contact

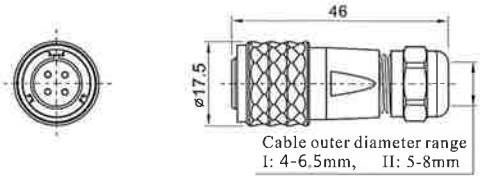

SF1211 / P — SF1211 / S

In-line cable connector
Mate with SF1210

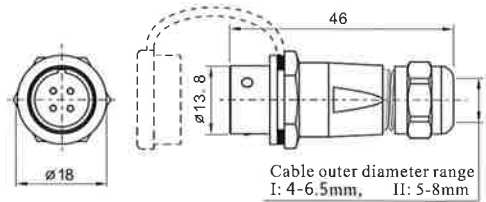

SF1212 / P — SF1212 / S

Rear-nut mount
Mate with SF1210

Number of contact

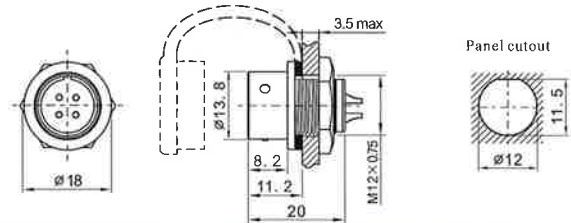

SF1213 / P — SF1213 / S

Square flange
Mate with SF1210

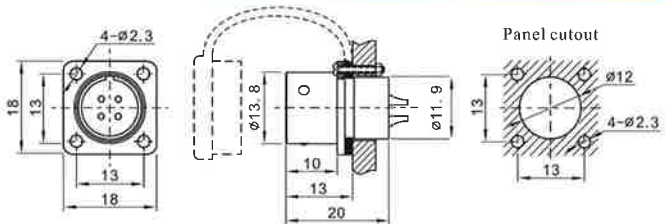

SF1214 / P — II SF1214 / S — II

Angled cable connector
Mate with SF1211, SF1212, SF1213

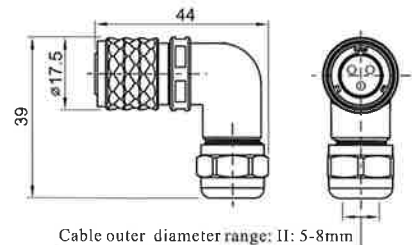

Cable outer diameter range: II: 5-8mm

Solder contact spec

Number of contact	2	3	4	5	6	7	9
Male contact face view							
Rated current (A)	13	13	5	5	5	5	3
Contact diameter (mm)	1.6	1.6	1	1	1	1	0.7
Rated voltage (AC.V)	250	250	200	180	125	125	125
Test voltage (AC.V) 1 min	1500	1500	1500	1000	1000	1000	1000
Contact resistance (mΩ)	2.5	2.5	5	5	5	5	10
Wire size (mm ² /AWG)	≤2/14	≤2/14	≤0.75/18	≤0.75/18	≤0.75/18	≤0.75/18	≤0.5/20